

REV.	ECN NO.	DESCRIPTION	SIGN	DATE
D1	N/A	INITIAL DRAWING	Peng	2013/04/08

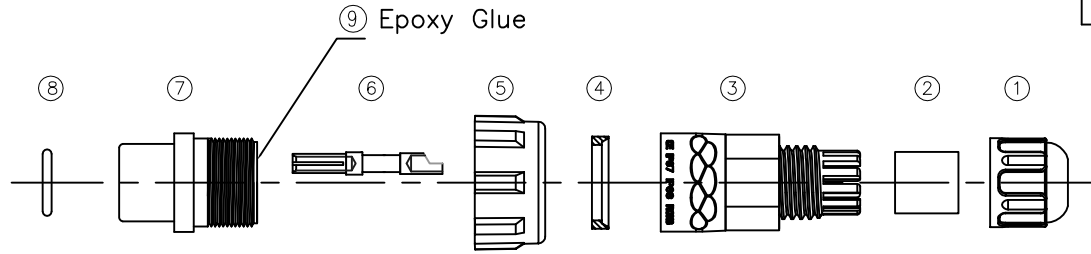
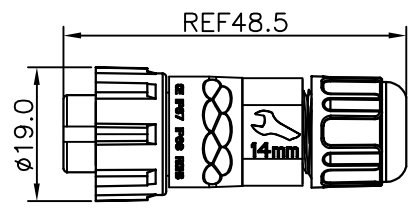

Table 1

Position No.	Connector Part No.	7 Housing Part No.	6 Contact		
			Contact Part No.	Q'ty	Contact Description
2	22002221-01	102-00163-00	302-00002-02	2	TPS1.5-A
3	22003221-01	102-00015-02	302-00002-02	3	TPS1.5-A
4	22004221-01	102-00024-00	302-00002-02	4	TPS1.5-A
5	22005221-01	102-00164-00	302-00049-02	5	ZPS1.0
6	22006221-01	102-00030-00	302-00049-02	6	ZPS1.0
2+4	22204221-01	102-00165-00	302-00002-02	2	TPS1.5-A
			302-00049-02	4	ZPS1.0
3+4	22304221-01	102-00166-00	302-00002-02	3	TPS1.5-A
			302-00059-02	4	TPS0.8
8	22008221-01	102-00032-00	302-00049-02	8	ZPS1.0
10	22010221-01	102-00193-00	302-00059-02	10	TPS0.8
12	22012221-01	102-00194-00	302-00059-02	12	TPS0.8



Specification:  
 1.Operation temperature:-45°C~105°C.  
 2.Insulation resistance:100MΩ at DC500V.  
 3.Contact resistance:<10mΩ.  
 4.Waterproof:IP67.  
 5.RoHS compliant.  
 6.Mating Waterproof Cap P/N:806-00033-00.  
 7.Mating Connector P/N:22XXX321-XX or 22XXX323-XX-001 or 22XXX525-XX.

Table 2 (Hole Arrangement, Mating Face)

2 Pos	3 Pos	4 Pos	5 Pos	6 Pos
300 v 10 A	300 v 10 A	125 v 10 A	60 v 5 A	60 v 5 A
(2+4)Pos	(3+4)Pos	8 Pos	10 Pos	12 Pos
60 v 10+5 A	60 v 10+2 A	60 v 5 A	30 v 2 A	30 v 2 A

Material List

No.	Material No.	Q'ty	Material Description	Remark
1	109-00004-00	1	103 Seals Nut	
2	502-00005-00	1	103 Seals Ring	
3	108-00009-00	1	103 Clamp Ring	
4	503-00020-00	1	103 Gasket	
5	107-00009-00	1	Standard Lock Nut	
6	See above table 1		Contact	
7	See above table 1	1	Standard-XX Pos Housing	
8	501-00015-00	1	O-ring φ12.6*1.3	

UNIT:mm		Description
TOLERANCE		Standard Series Lock Assembled, Socket Male Connector(Short)
.X	±0.25	
.XX	±0.15	
.XXX	±0.05	
ANGLES	±1°	
SCALE: N/A	SHEET 1 OF 1	
REV. D1	SIZE A4	QC: Inspection Item

**CHOGORI USA Inc.**

PART NO	22XXX221-01	DRAWN BY	PENG	DATE	2013-04-08
DWG NO		CHECKED BY		DATE	
CUSTOMER		APPROVED BY		DATE	

THIS INFORMATION IS CONFIDENTIAL AND IS DISCLOSED TO YOU ON CONDITION THAT NO FURTHER DISCLOSURE IS MADE BY YOU TO OTHER THAN CHOGORI PERSONNEL WITHOUT AUTHORIZATION FROM CHOGORI CORP.